

Low Voltage Electric Panels

Earthing and Short - Circuit Equipment

SAFETY CATALOGUE



Low voltage electric panels

Mod. ECBT-MPUE

Earthing and short-circuit equipment for low voltage electric panels. The main aim for its installation is operator's protection against an accidental commissioning or possible voltage return during repair operations.

The MPUE clamps can be fixed on bare cylindrical conductors, flat bars, bending bus-bars or fixing points. Each one has its own fixed handle.

According to IEC 61230 standard.

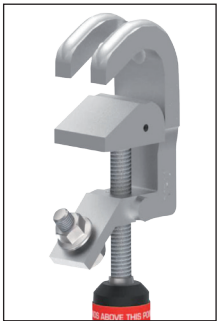
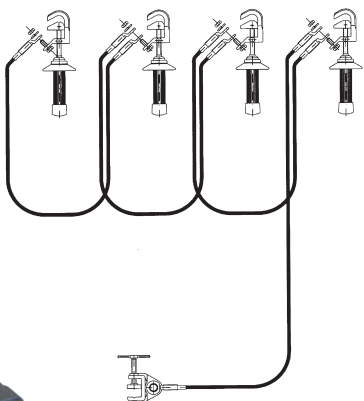

MPE
Low voltage clamp

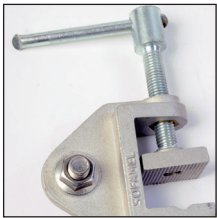

TT-38A
Earthing lathe

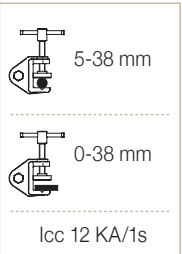

Composed of:

- 4 MPUE aluminium alloy clamps with screw tighten and handle insulated grip.
- 3 copper cables with PVC insulation of 35 mm² section and 0.6 m long.
- 1 copper cable with PVC insulation of 25 mm² section and 2 m long.
- 1 TT-38A milling earthing lathe.
- 1 plastic case to store and transport the equipment.



Code	Ref.	Short circuit current Max. ICC
659000	ECBT-MPUE/35	9 KA/1s